



[www.ThompsonAP.com](http://www.ThompsonAP.com)

DIVISION OF  
AMERICAN MADE  
AWNINGS OF HOLLYWOOD  
954-963-7717



We design, manufacture and install truly innovative outdoor solutions, serving the needs of the residential community. Whether it be rain, wind, sun or heat, our creative outdoor solutions will provide you with shelter while maximizing your outdoor area. We make ordinary environments, extraordinary.

# Welcome to Thompson Architectural Products

A DIVISION OF AWNINGS OF HOLLYWOOD

*For more than 40 years and three generations of family ownership and management, our company has served the needs of the residential community in South Florida. We have many satisfied customers who have helped us to maintain and grow our business.*

Thompson Architectural Products evolved out of American Made Awnings' growth due to expansion of products and services into the commercial markets. Even though we have widened our customer base and product selection, we are still dedicated to residential consumers. Through the technological advances that we have embraced over the years, we are now able to offer a wider range of products to address the needs of today's homeowners. The custom designed structures on the following pages will illustrate the creative solutions we provide to help you make the right decision for your home. We continue to maintain the best in quality materials, workmanship and customer service throughout the Continental U.S., Canada and the Caribbean.

*Let us help you find the best solution for your shade or weather protection needs. Please give us a call and one of our estimators will be glad to assist you with the options available to maximize the functionality and aesthetic appeal of your living space.*





## TABLE OF CONTENTS

- 4 Window and Door Awnings
- 10 Carports
- 12 Patio Awnings
- 18 Thompson Weathershield Shades & Screens
- 22 Thompson Weathershield Slide Curtains
- 24 Retractable Awnings
- 28 Retractable Roofs
- 32 Tension Structures and Sails
- 36 Metal Trellises
- 38 Cabanas

**Window and Door** awnings are available in a number of different styles. Shown below are the most commonly used shapes. All of our products are custom built and unique shapes can be designed to accommodate building conditions as well as decorative themes, as shown in these photos.

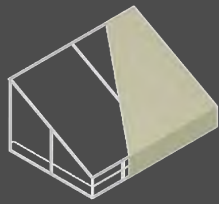

Lean-to

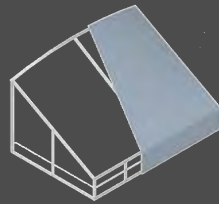

Curved Lean-to

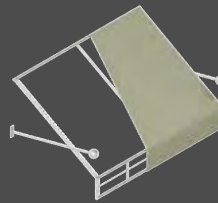

Open ended Lean-to with Decorative Arms

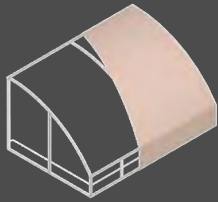

Convex Lean-to

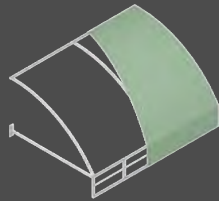

Open ended Convex Lean-to

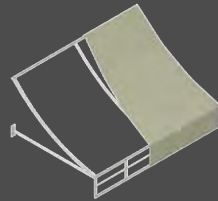

Open ended Concave Lean-to

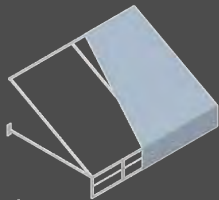

Open ended Lean-to with Arms

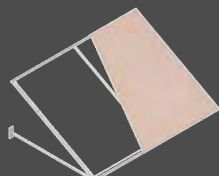

Slope Style

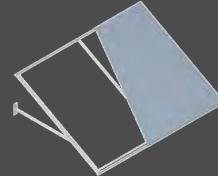

Slope Style with Mid Arms

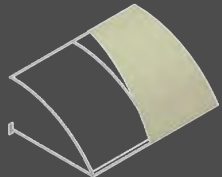

Convex Slope Style



Bull Nose (Dome)

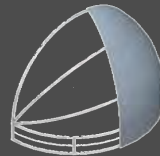

European Dome

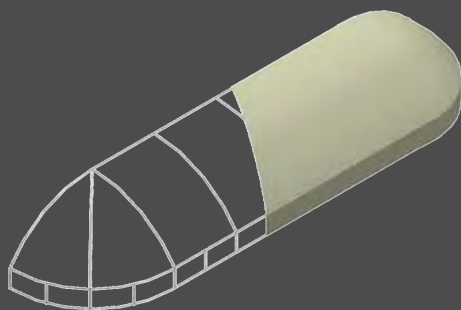

Elongated Dome



**Entry Awnings** are a great way to present a welcoming feel to the entry while providing shelter from the sun and rain.

A graphic design lends a flair to this entryway. ▼





◀ *European Dome* Awning

An *Elongated Dome* awning serves as a decorative solution for shade and rain protection at this entry door. ▶



◀ Dome or Bull Nose awnings are often used in conjunction with other styles of awnings.



Three variations of *Concave Awnings*



Spear-tipped backarms ▲

▼ Ball-tipped backarms





◀ *Lean-to* Awning

▼ *Round Top* Awning



*Slope Awnings* over  
▼ Doors And Porch Openings







▲ Custom **Lean-to** Awnings designed for limited headroom

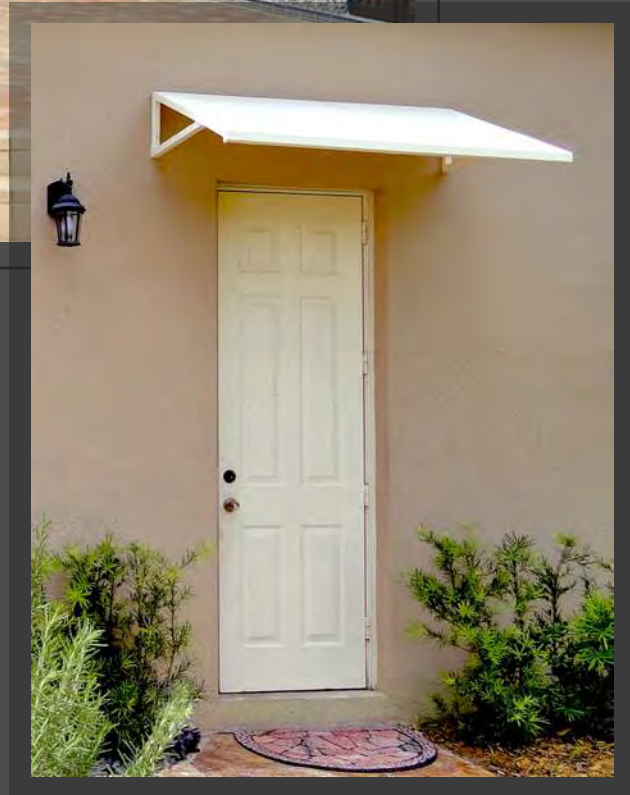

▲ Cantilevered **Slope Style** Awning



◀ **Bull Nose** Awning and a **Hybrid** Awning consisting of a Lean-To with a Rounded Top and Frontal Beam



**Carports** serve to protect your vehicle from the harmful rays of the sun while keeping it cool and shaded. It also provides shelter from the rain and airborne debris from nearby trees and bushes.

**A-Frame ▲**

**▼ Hip Roof with Vent**





**Modified A-Frame ▲**

Custom styles can enhance or accent the design of your home.



**Lean-to ▼**

**Round Top ►  
with Curtains**



Structural Gutter is only used when there is limited headroom available. Awning frame is otherwise attached directly to the building.

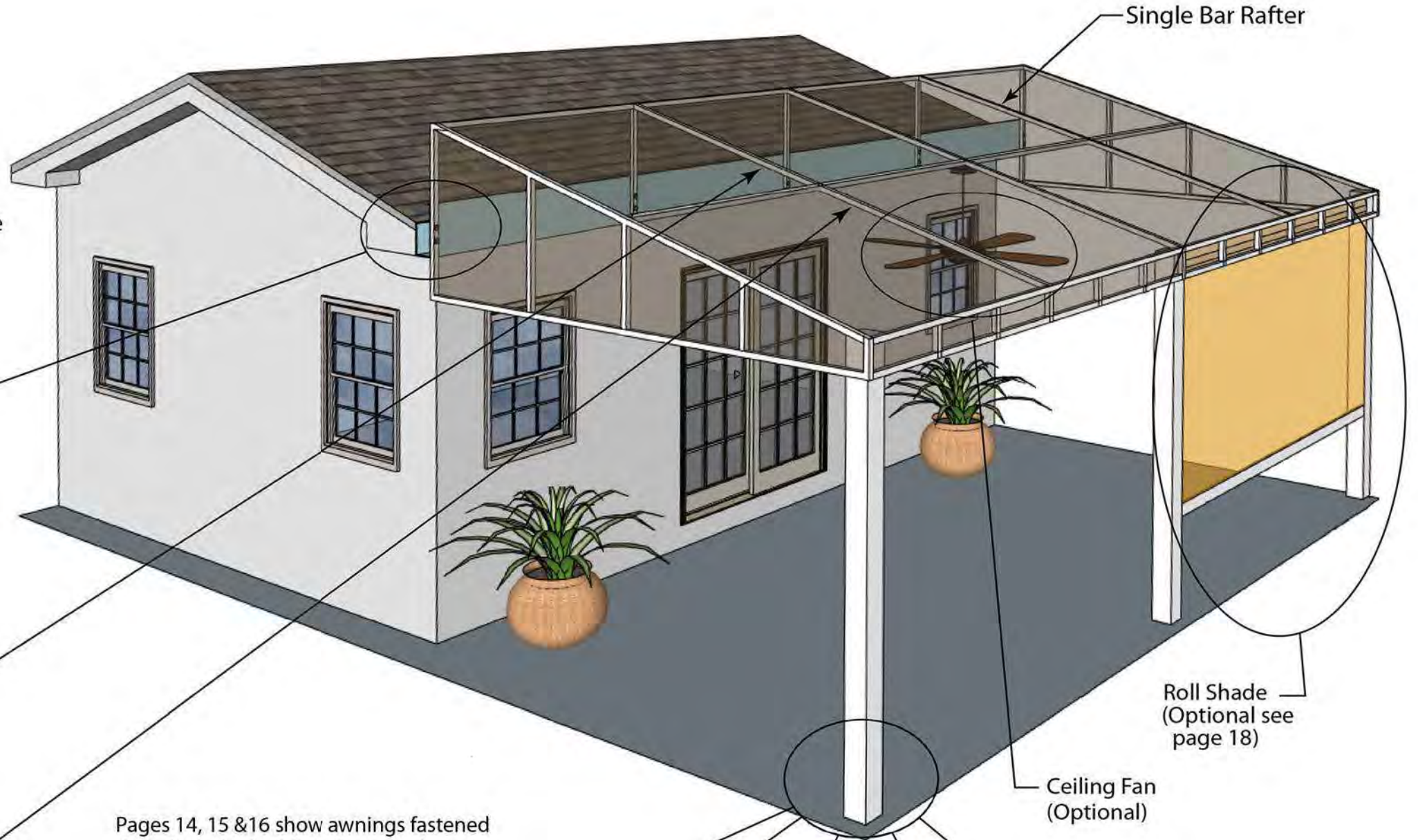
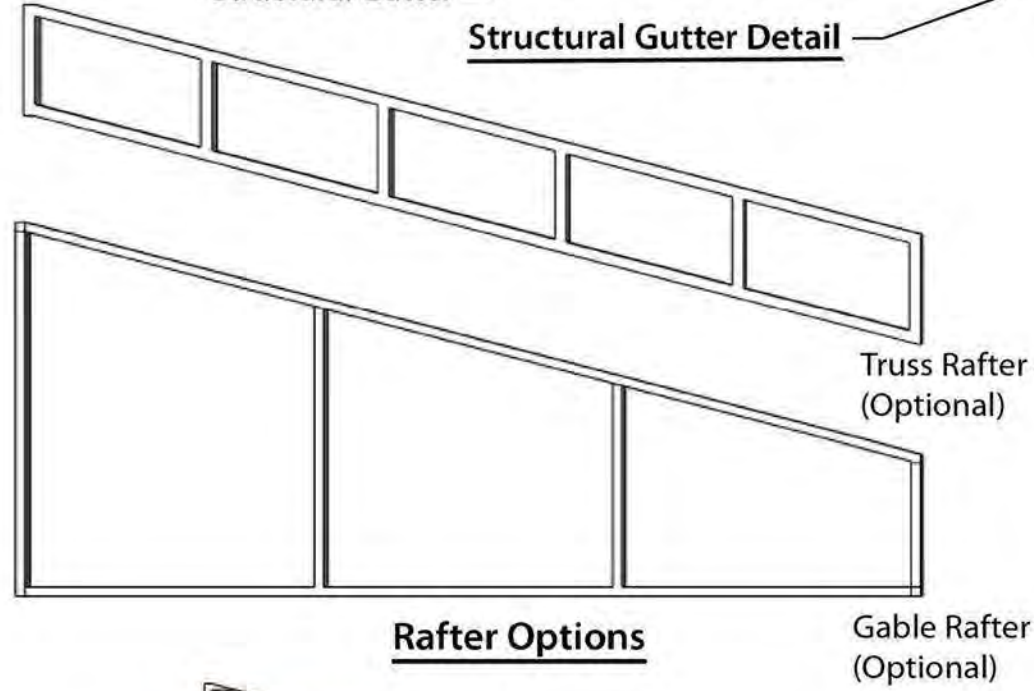
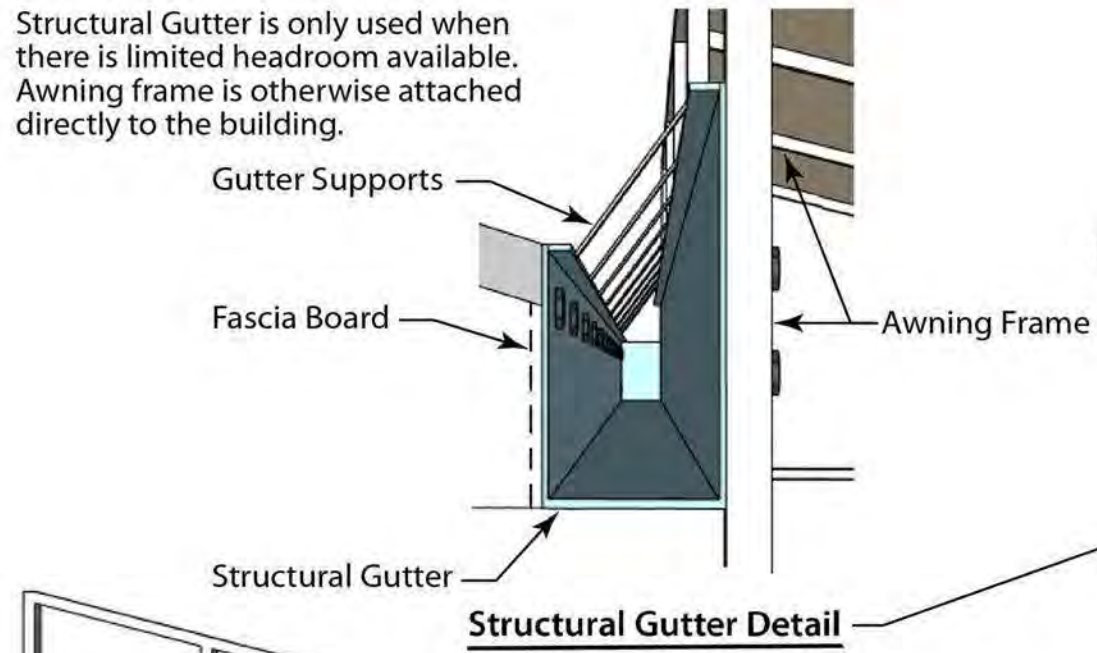

Pages 14, 15 & 16 show awnings fastened directly to the building. Structural gutter applications can be seen on pages 16 & 17.

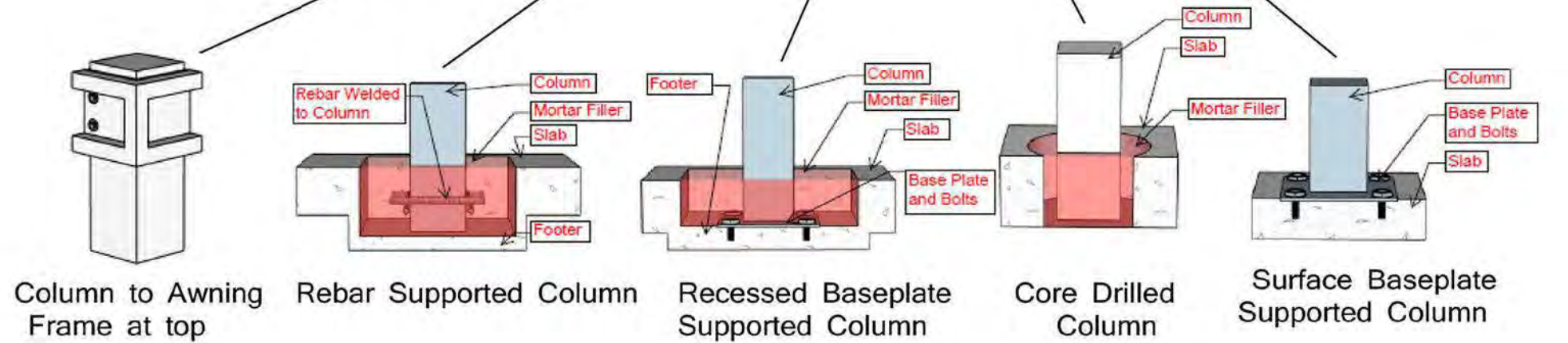

**Column Bottom Mount Options**



◀ This awning follows the roofline of the house. Sliding curtains have been installed at each end to provide privacy as well as a windbreak.

An investment in **Patio Awnings** can add a whole new element to your lifestyle. Make the best use of your outdoor space. Accessories such as fans, lights, curtains, roll down shades and heaters can be added to maximize your outdoor experience.



▲ A **Trellis style** frame is accented with a colorful fabric cover. String lighting was added, to create a festive atmosphere.



▲ An **A-Frame** patio awning is accessorized with **Roll Down Solar Shades** and a **Ceiling Fan**. ►



An inviting outdoor look is achieved with the addition of **Sliding** ▲  
**Solar Curtains**, a **Ceiling Fan** and comfortable outdoor furniture



▲ A **Cantilevered Slope** awning provides sun and rain protection allowing use of the patio in all weather

◀ **Structural Gutter** is used as the solution to a porch with a low roofline. The gutter is fastened to the house and the awning is then fastened to the gutter.

A modified **A Frame** awning is accessorized with a roll down solar shade to block the morning sun. ▼

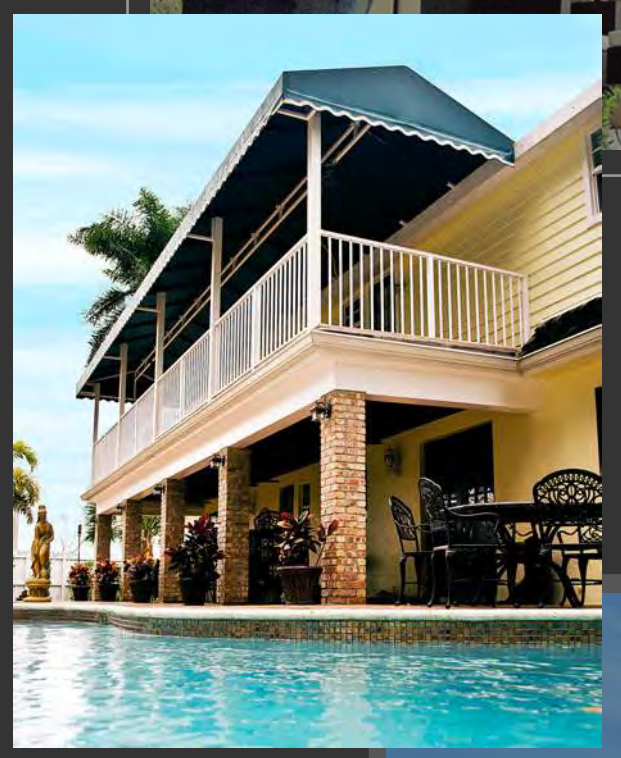

A **Structural Gutter** ► was used to mount the awning to the existing fascia board.

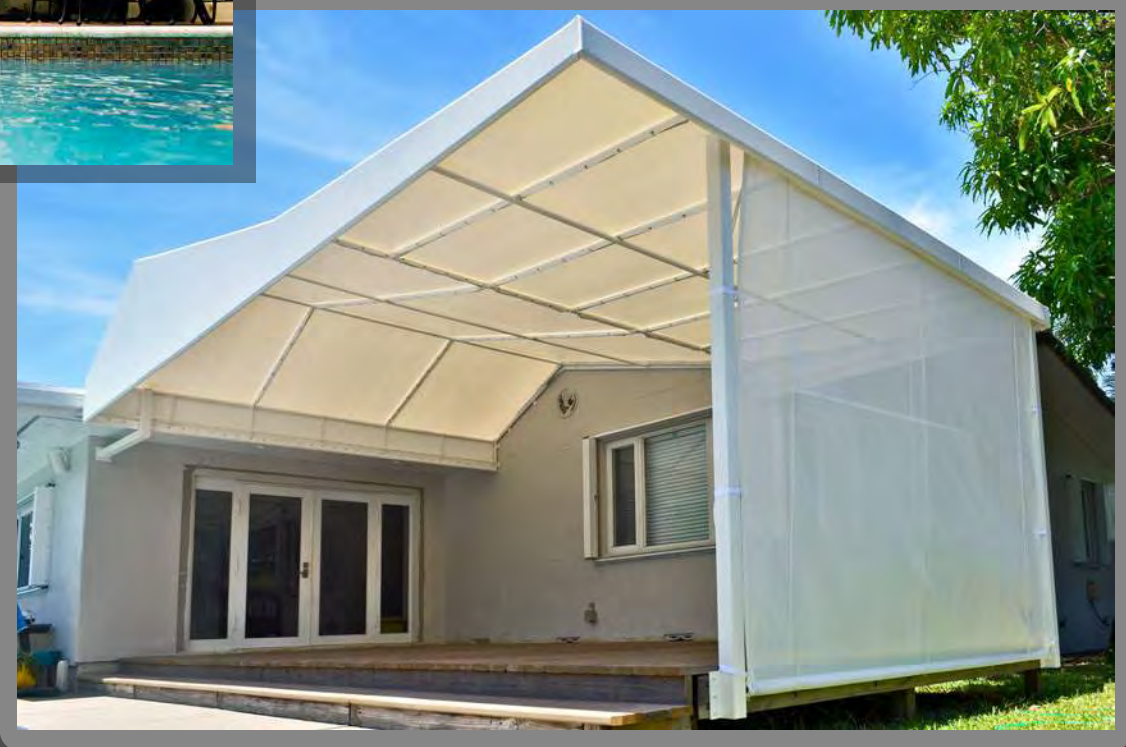



**Vented Roof** awning ▲  
with **Structural Gutter**

An outdoor kitchen with **Lighting** and ►  
**Ceiling Fans** is protected from the elements

A **Slope Awning** with custom curved  
arms covers the outdoor bar area ▼







▲ **Thompson Weathershield 'All Weather Shades'** with clear vinyl inserts  
**Weathershield 'Insect Shades'** available with 'no see-um' screen fabric ▼



The **Thompson Weathershield** roll down shade is designed with an internal spring system to maintain tension on the fabric at all times. This allows the shade to be operated under windy conditions, unlike typical gravity fed systems. Weathershield technology is available with different fabrics designed for different purposes. **Vinyl** fabric is utilized for rain and wind protection. It can be fitted with clear vinyl inserts allowing visibility and light. **Mesh** fabric is used for solar shades to filter light, heat and UV rays. **Insect screen** is used to keep out pesky bugs.

**Weathershield 'Solar Shades'** are available with different grades of mesh to allow varied percentages of light and air

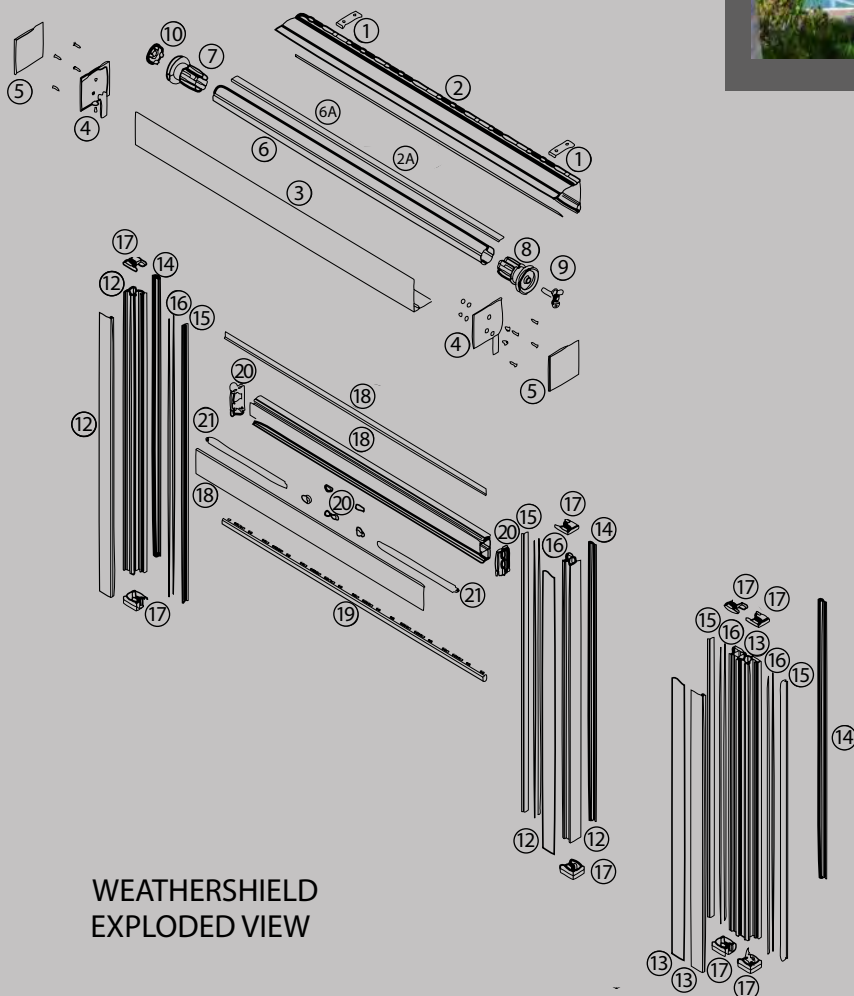

WEATHERSHIELD  
EXPLODED VIEW

1. Wall/Ceiling mounting brackets
2. Upper cassette profile
- 2A. Gasket
3. Lower cassette profile
4. Cassette end covers
5. Cover for cassette end covers
6. Roller tube
- 6A. PVC spline for roller tube
7. Motor shaft housing
8. Bearing shaft housing
9. Plate with bearing pin
10. Motor bracket
11. Zipper
12. Track set profile
13. Middle track set
14. Track cover profile
15. Inside track profile
16. Gasket
17. Track end caps
18. End bar set profiles
19. Gasket
20. Tightening kit and bottom rail caps
21. Spring



*Solar shades* filter the glare ▲  
and heat of intense sunlight ►  
*All-Weather shades* allow visibility while  
keeping out the cold, wind and rain ▼





▲ *Solar shades* offer protection from windblown sand as well as morning sun at this beachfront home

▼ *Retractable Screens* keep this porch insect free and ready to enjoy any time of the year



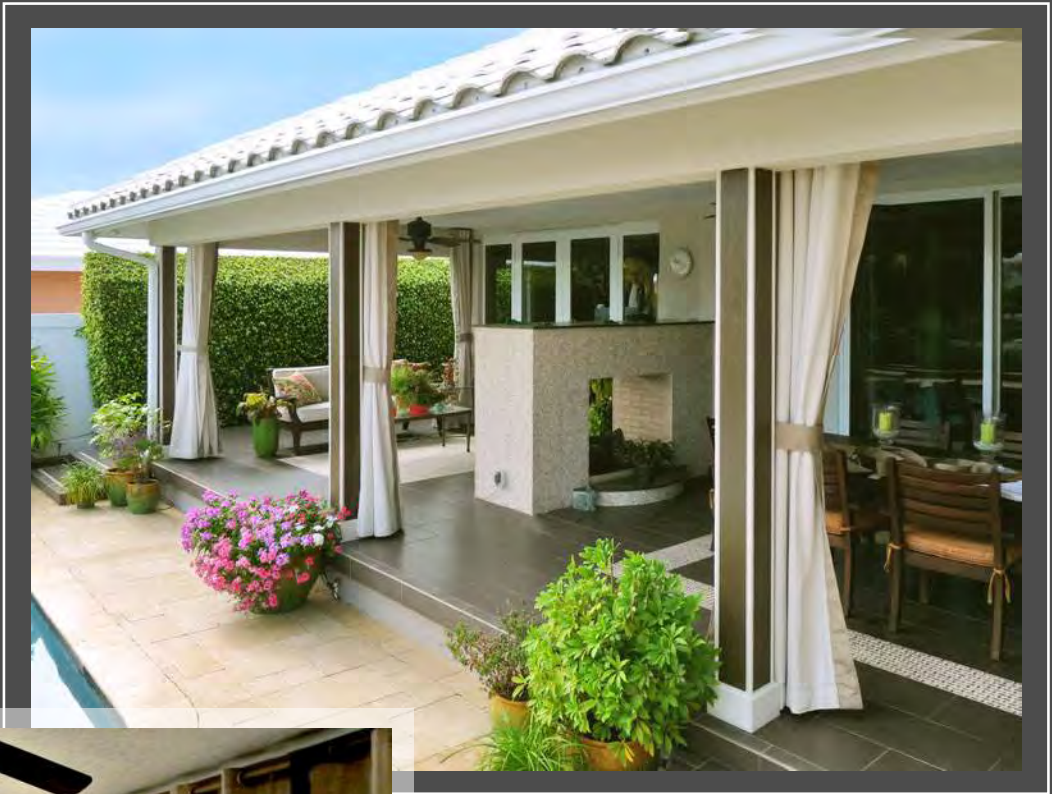

**Curtains** are neatly secured with tie-backs when not in use.

**Mesh Fabric** allows air and light into the room while providing privacy and UV protection



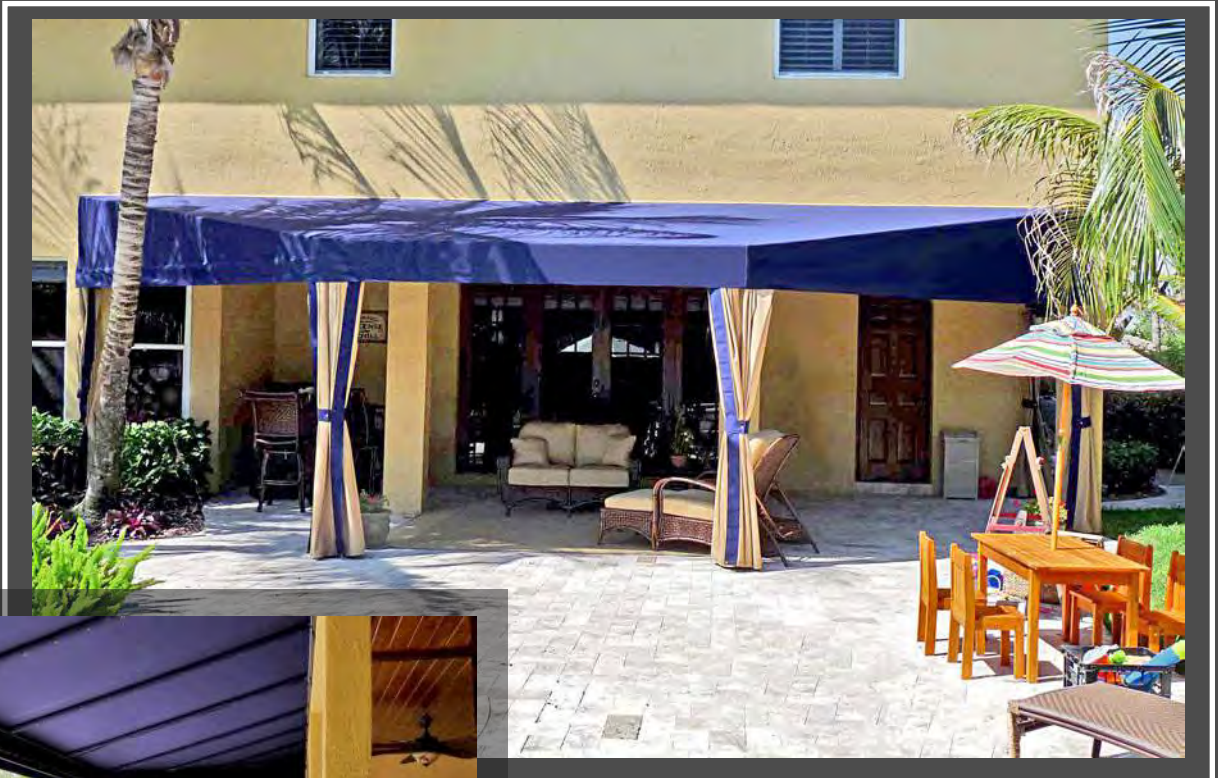

A patio awning and solar curtains transform deck space into a comfortable outdoor living area



**Retractable Awnings** can be mounted on the wall...

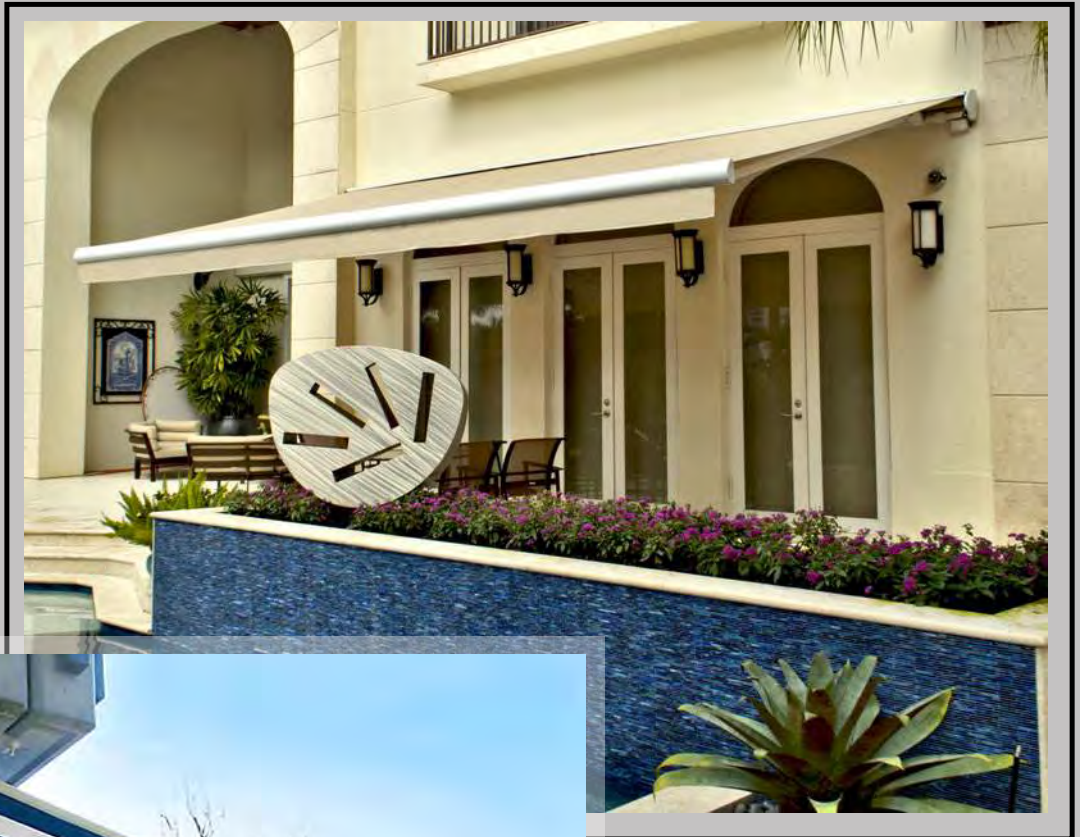

**Retractable Awnings** can be mounted under a soffit or beam as a ceiling mount...



**Retractable Awnings** can be mounted on a roof when headroom is a problem



A large **Retractable Awning** ►  
adjusted to a steep angle  
to maximize shade  
coverage



Awning in extended position ▲  
In the retracted position, fabric is ►  
housed in a protective cassette  
formed by the meeting of the wall  
mounted housing and the front bar

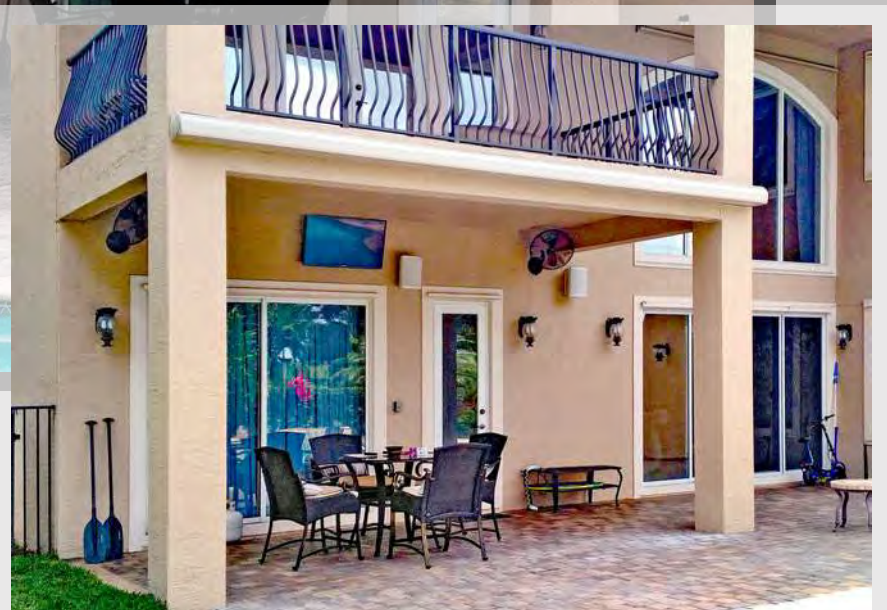





Roof Mounted **Retractable Awning**

The height of the available mounting area is sometimes too low to allow for a sloped awning. In such a case the awning can be installed on the roof.



The awning in the retracted ▲  
and  
◀ extended positions



Mounting brackets are fastened to the roof and sealed to prevent water intrusion. The retractable awning is then installed into the brackets.

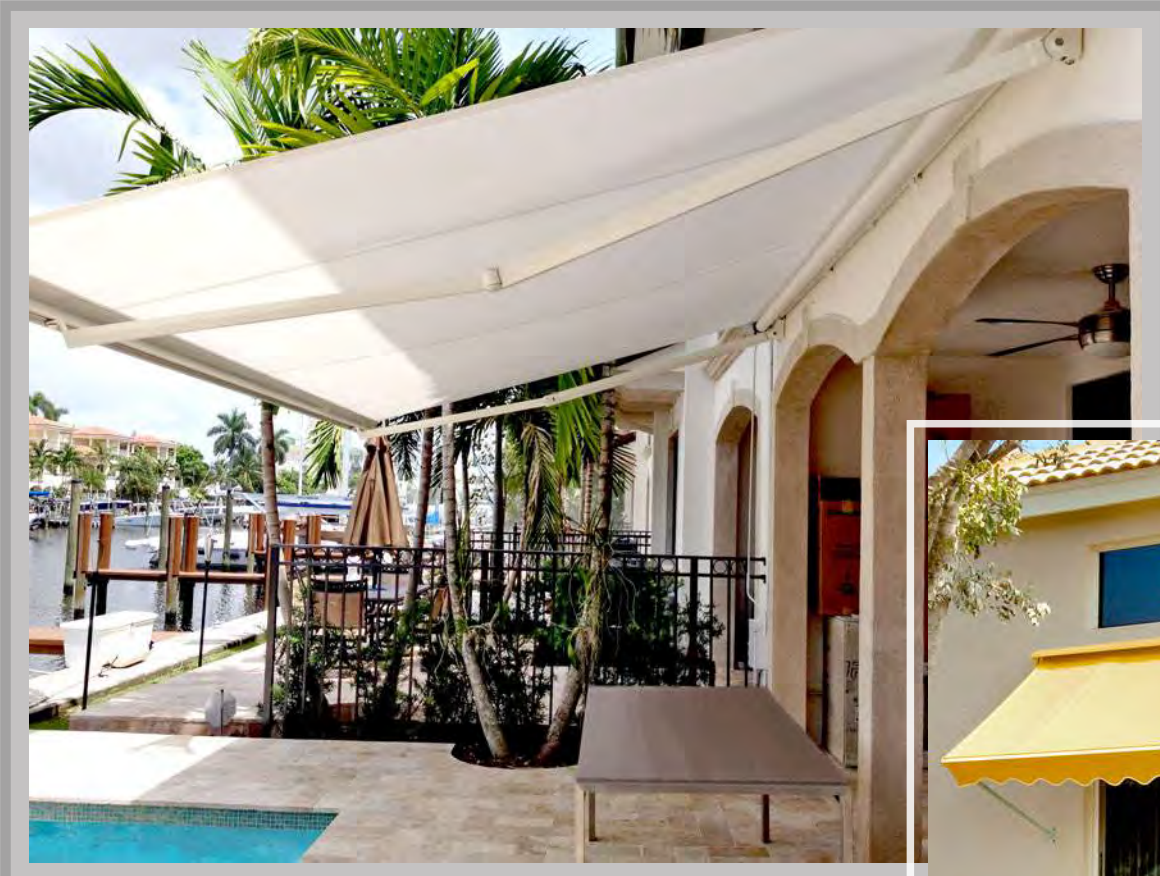

The **Lateral Arm Awning** meets the needs of most consumers ▲

The manually operated **Drop Awning** is the most economical version in the retractable awning product line ►



▲ The **Telescopic Arm Awning** can withstand heavier wind and rain conditions than other retractables. The pressurized arm design keeps tension on the fabric and results in a much more stable awning.



*Retractable Roofs* are available in a variety of styles. From sloped to curved, free standing to cantilevered, there is a design made to suit your needs. With the push of a button you can enjoy the sun or the evening stars. When the rains come, simply push the button and stay dry.

A curved frame softens ▲ the look of this lineal design.

Sloped roof with a metal frame, powder coated with a wood ► grain finish

Flat frame with swag roof panels ▼





Cantilevered roof with contoured ▲ support arms

Curved cantilevered roof with tension arms from above and integrated lighting ►



Free standing frame with **Retractable Roof** adds a whole new dimension to this backyard. ►





***Retractable Roofs...***  
can be opened to reveal the stars at night or let you work on your suntan during the day. When you've had enough sun or the rain comes, simply press a button to shelter yourself from the elements.





Designed to handle wind, rain and even snow loads, these roofs have a built-in gutter system to deal with water management.



***Sail Shades*** at the front entry and over the pool deck at the rear, create a theme for this home.





Cabana style **Tension Structures** on the sundeck provide shade, wind protection and privacy.







An outdoor kitchen and a roof top deck are shaded by **Tension Sails**.





Exposure to harsh afternoon sun is remedied with the use of two unique solar *Tension Designs*





A waterfall was incorporated into this *Metal Trellis* design. The top of the trellis features a horizontal *Retractable Solar Shade* to provide shelter from the sun.



A cantilevered *Trellis* adds a new dimension to this patio. *Cable Railing* on the second floor compliments the trellis design.





A metal frame is accented with an exotic ▲▶ hardwood design creating a beautiful rooftop trellis

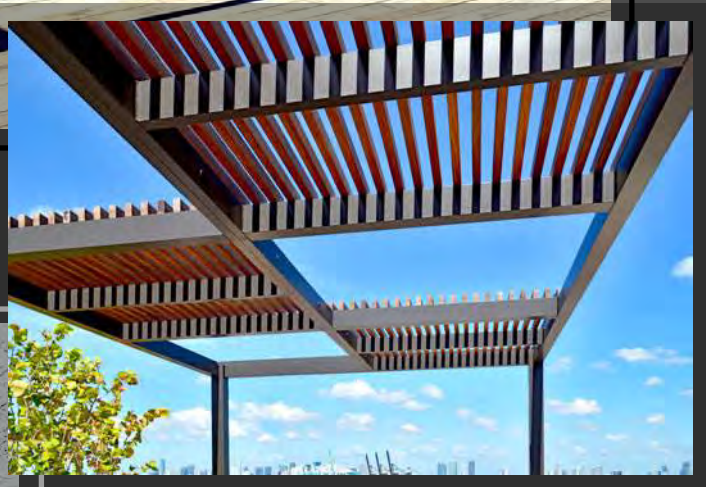

◀▲ An Arbor/Trellis will soon become a welcoming flowered entry way

**Cabana** designs vary depending on their primary use.



▲ The **Cabana** pictured above serves as an extension to the home, with a TV, **Ceiling Fan**, speaker system and comfortable furniture.



◀ An outdoor kitchen is sheltered from the elements and is kept cool by two **Ceiling Fans**.

A **Retractable Roof, Curtains** and inset **Lighting** highlight this A-frame poolside **Cabana**.





◀ **Vented Roof Cabana** with sliding privacy **Curtains**.



▲ This octagonal **Cabana** allows hot air to escape through the vented roof.

◀ A waterside **Cabana** creates a scenic and relaxing atmosphere.



Mounted on a floating ► dock, this **Cabana** protects the watercraft from the damaging rays of the sun.



**Call or visit us to learn more about our distinctive product lines**



**Before**



**Rendering**



**After**



**After**



**THOMPSON**  
ARCHITECTURAL PRODUCTS

[www.ThompsonAP.com](http://www.ThompsonAP.com)

DIVISION OF  
AMERICAN MADE  
AWNINGS OF HOLLYWOOD

[AWNINGSOFHOLLYWOOD.COM](http://AWNINGSOFHOLLYWOOD.COM)

**5828 Washington Street, Hollywood, Florida 33023**

**954-963-7717**

**888-745-3671**